

508

Non-return ball valve

B System

Technical Data Sheet



Description

The non-return ball valve 508 consists of a self-cleaning ball lifted by the fluid and guided to a lateral seat, completely out of the way. This system provides a full-flow, even with loaded fluids, without any risk of blockage.

- Vertical and horizontal operation (position of the ball above the axis of the pipe)
- Minimum head loss
- Silent, robust
- Non incrustating materials
- Sealing ensured by an elastomer seal fixed on the seat



508

Non-return ball valve - B System

DN		PFA in bar	PS in bar				Cat.	Ref.	Weight Kg
"	mm		L1	L2	G1	G2			
1	25	10	10	10	10	10	4.3	149B3202	1,30
1 1/4	32	10	10	10	10	10	I	149B3203	1,90
1 1/2	40	10	10	10	10	10	I	149B3204	2,45
2	50	10	10	10	10	10	I	149B3205	3,50
2 1/2	65	10	10	10	10	10	I	149B3206	5,90

Important notice :

The indicated pressure for the different categories of fluids (L1/L2/G1/G2) is under no condition a guarantee of use. Therefore, it is essential to validate the use of products under given operating conditions. The operating instructions are available on our website www.socla.com or by requesting from our sales department.

Technical features

Operating temperature	-10 °C to 80 °C
Permissible operating pressure (PFA) in water	See table above
Maximum permissible pressure (PS) other mediums	See table above
Connection	Female/female, G cylindrical gas thread
Mediums	Wasted water, viscous liquids, loaded liquids , thick liquid, gas

Nomenclature and materials

N°	Description	Materials
1	Body	Cast iron / Epoxy ext
2	Cover	Cast iron / Epoxy
3	Ball density 1,30	Thermodur
4	Seal	NBR (nitrile)
5	Seal	NBR (nitrile)
6	Nut	Stainless steel A2
7	Washer	Stainless steel A2
8	Screw	Stainless steel A2

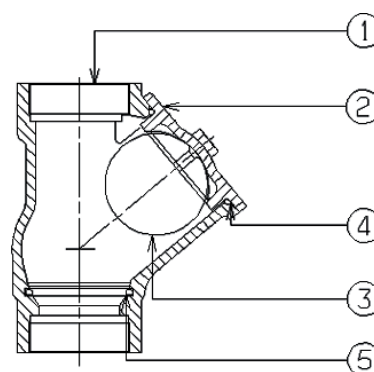
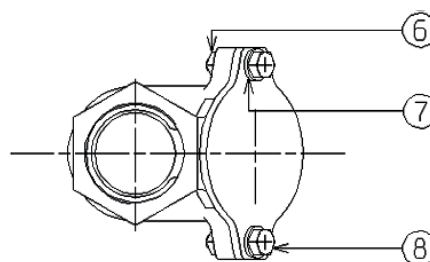

Approvals



International construction Standards :

CE Directive 2014/68/UE

CE conformity regulation 305/2011/UE Standard EN12050-4

Thread connection according to NF EN ISO 228-1

Application

Wasted water, viscous, thick and loaded liquids, gas.

Operation

Direction for use :

- Solid line: Valve completely open

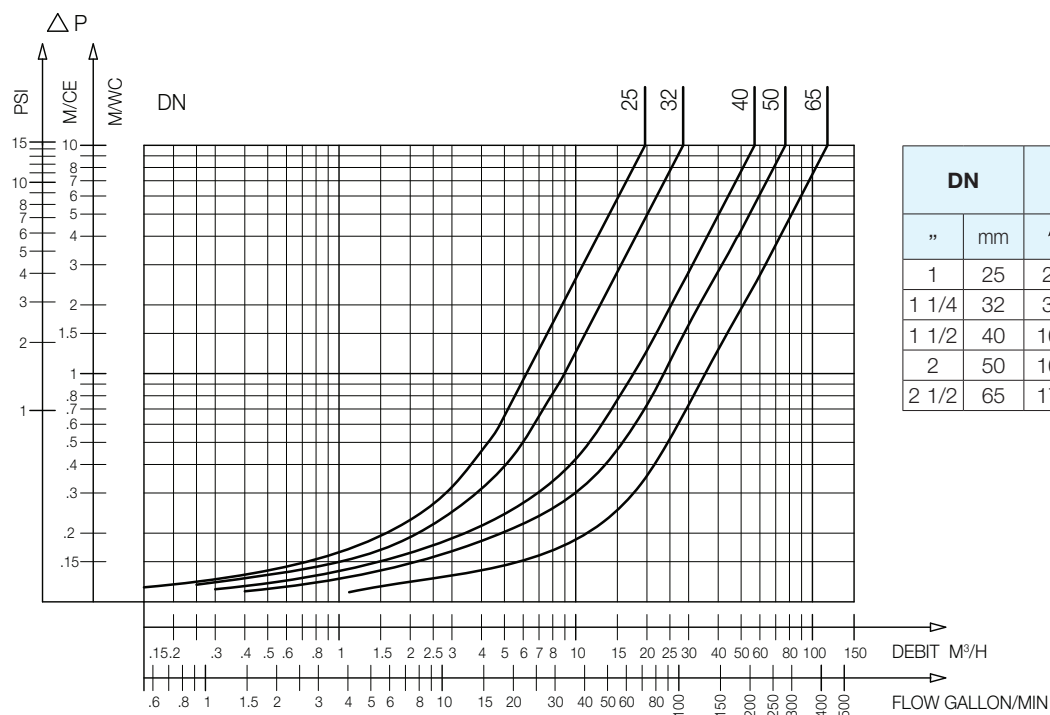

508 - Headloss chart

Sizing

A		RB	C	D
"	mm	mm	mm	mm
1	26/34	76	114	95
1 1/4	33/42	85	132	110,5
1 1/2	40/49	93	145	121
2	50/60	107	173,5	144
2 1/2	66/76	127	200	174,5

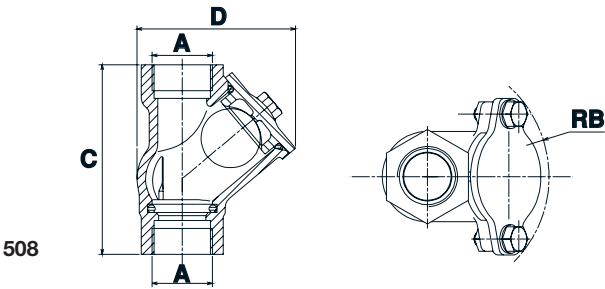

The descriptions and photographs contained in this product specification sheet are supplied by way of information only and are not binding.

Socla reserves the right to carry out any technical and design improvements to its products without prior notice. Warranty : All sales and contracts for sale are expressly conditioned on the buyer's assent to Socla terms and conditions found on its website at www.socla.com. Socla hereby objects to any term, different from or additional to Socla terms, contained in any buyer communication in any form, unless agreed to in a writing signed by an officer of Socla.



Socla sas
365 rue du Lieutenant Putier • 71530 Virey-Le-Grand • France
Tel. +33 03 85 97 42 00 • Fax +33 03 85 97 42 42
contact@wattswater.com • www.socla.com
ISO 9001 version 2015 / ISO 18001